

LOCATION & REMOVAL

Installation is made at the screen control unit (1) located behind the glove box in the Q7, A6 and A8 (3&4) The Glove Box is secured with 3 screws at the inside top edge and 3 screws outside at the bottom.

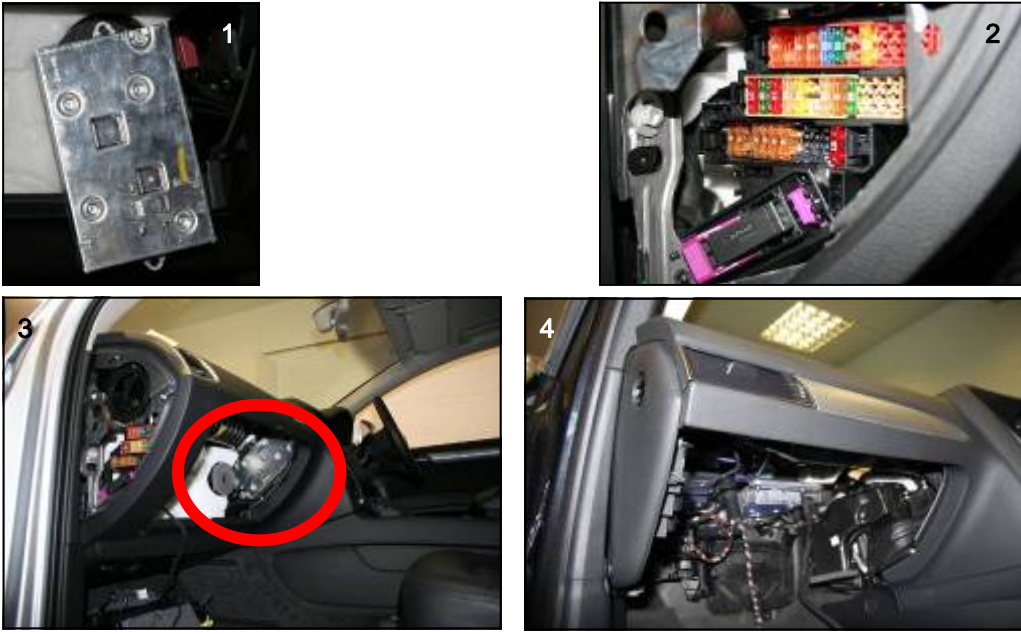

Installation on the new A4 and A5 is made at the screen control unit (1) located behind the CD changer and heating controls in the centre consol of the dash. The CD changer unit is removed with AUDI removal keys.

The screen control unit is secured with 2 screws, remove these and unplug the unit. **Q7 ONLY**; Next remove the mounting plate (also 2 screws) and cut the tie securing the loom. Re-route the loom to above the mounting bracket and then re-fit the bracket. This will give you easier access when re-fitting the screen control unit.

When re-fitting (after installation of the supplied cables) mount the screen control unit upside-down to make cable routing easier.

Remove the dashboard side panel to access the fuse holders (2) this is where you can find 12v+ (Accessory) 12v+ (Permanent) and 12v- (Ground). See installation for more details.

INSTALLATION

Power and other connections

Power connections are made at the passenger side fuse holder and at the **RED/BLUE plug from the screen control unit.**

Connect the RED cable to the 12v+ Accessory (in Fuse holder)

12v+ Accessory can be found at the fuse holder C (black), see photo below

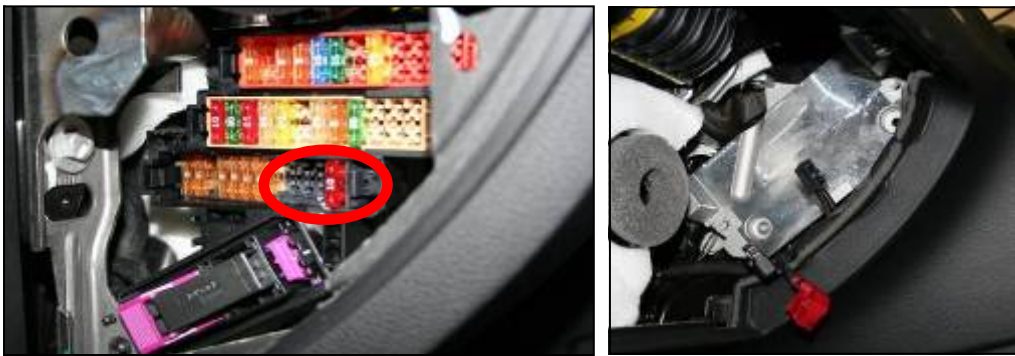

The Following Connections are made at the RED plug removed from the screen control unit.

Connect the **WHITE** cable to the WHITE/GREY Cable found in **pin 16** of the RED plug (button press pick up)

Connect the **YELLOW** cable to the RED/YELLOW cable found in **pin 1** of the RED plug or preferably at the fuse holder A (red) (12v+ Perm)

Connect the **BLACK** cable to the BROWN cable found in **pin 2** of the RED plug or preferably to a ground point (12v- Ground)

Connect the **BLUE** cable to a 12v+ supply to trigger the reverse camera input (reverse light 12v+ may require a relay if low current)

Plug this loom into the interface (marked POWER 1 & POWER 2)

Plug the supplied lead into the screen control unit, and into the interface (marked **TO CONTROL UNIT**)

Plug the black plug (you removed from the screen control unit) into the interface

OPERATING INSTRUCTIONS

SWITCH 1 on activates RGB input

SWITCH 2 on activates AV1 input

SWITCH 3 on activates AV2 input

SWITCH 4 N/A

SWITCH 5 on activates CAMERA input

SWITCH 6 on activates FACTORY NAVIGATION

ALL OTHER SWITCHES ARE NOT USED IN THIS APPLICATION.

To select the your added RGB source (if activated) to appear on the screen you need to press the NAV button on the display controls once. Pressing the NAV button a second time will select the A/V source **AV1** (if activated) Pressing the NAV button a third time will select the A/V source **AV2** (if activated) Pressing the NAV button a fourth time will select the factory navigation system. The audio will change from factory audio i.e. radio to that of the added A/V source at the same time as the video is selected. If RGB is not activated then pressing the NAV button once will select the A/V input **AV1**, and pressing a second time will select the A/V input **AV2** etc.

E.g.

If RGB input only is needed then switch 1 should be on and all others off.

If AV1 input only is needed then switch 2 should be on and all others off.

If both RGB and AV1 are needed then both switch 1 and 2 should be on.

If the Factory Navigation is needed then switch 6 should be on.

In the unlikely event that you wish to alter the screen input brightness or contrast the controls are found on the side of the interface next to the **TO CONTROL UNIT** socket

BUTTON 1 = DOWN

BUTTON 2 = UP

BUTTON 3 = MENU e.g. contrast or brightness

INSTALLATION

Connect the supplied optical cables to the optical cable from the screen control unit as follows;

Insert the vehicle's **OUT** optical cable into the supplied cable jointing connector and supplied cable into car plug to create a loop, take note of the arrows on the plugs see diagram below.



You will need to remove the **OUT** optical cable from the factory connector (you will need to push out the small blue locking insert to remove it) and insert the **OUT** optical cable from the factory connector into the supplied Jointing connector and press shut, You will then need to insert the other supplied cable (**connected to the supplied plug side marked IN to the interface**) into the now empty **OUT** location of the factory connector and replace the small locking insert. (shown above)

Note;

Do not remove the fibre optic cable marked IN from the factory connector.

When loop is complete insert the supplied plug into the interface (marked **MOST OPTICAL IN/OUT**)

Plug in the supplied looms to the sockets marked **AV INPUTS / CAMERA IN** and insert your **AUDIO** and **VIDEO** signals and **CAMERA** signal as required. Insert the **AUDIO OUT** plug to the **AUDIO IN** cable socket in the plug marked **POWER 2**.

The interface can also use an RGB input, this loom is inserted into the socket marked **RGB INPUT** and if used will need **SWITCH 1 ON**. The loom is colour coded,

PIN 1 Red Input (Red)	PIN 4 Sync Input (White)
PIN 2 Green Input (Green)	PIN 5 Audio/RGB Ground (Black)
PIN 3 Blue Input (Blue)	PIN 7 & 8 Left (white) & Right (orange) Audio input

COMPATIBLE PRODUCTS

NAVTV also have an iPod interface compatible with AUDI vehicles with the MMI system. The AUD-iPOD features full control of the iPod from the factory controls plus charging of the iPod.



TROUBLE SHOOTING

Q; Input does not appear on pressing the NAV button?

A; check you have connected the WHITE cable to the car RED plug correctly

A; Check you have the required switches set to ON

Q; There is no audio from the input or factory radio etc?

A; check your fibre optic connection, you should pull the optical cable plug from the interface and check you have red light from the in arrow cable. If yes check power feeds to the interface.

A; check you have connected the AUDIO OUT plug to the AUDIO IN cable socket.

There is no display at all?

A; check the black plugs marked TO CONTROL UNIT and TO SCREEN.

There is display but there are lines in the picture?

A; check the black plugs marked TO CONTROL UNIT and TO SCREEN are fully locked.

INTERFACE DIAGRAM



- 01 OPTICAL IN/OUT
- 02 TO SCREEN
- 03 MENU / UP / DOWN BUTTONS
- 04 TO CONTROL UNIT



- 05 SWITCH SETTINGS
- 06 RGB INPUT
- 07 AV-1 INPUT
- 08 AV-2 INPUT
- 09 CAMERA IN / AUDIO OUT / VIDEO OUT
- 10 POWER 1
- 11 POWER 2



AV-MMI

A/V INPUT
AUDI A6 / A8 / Q7 MMI
Without TV Tuner

NAV TV (Europe) LTD



NAV TV (Europe)

Distribution Centre
Unit 21B Vale Business

Telephone: + 44 (0)8445
783 783